

CONECTOR MACHO RJ45 DE INSTALACIÓN EN CAMPO - THE LYRA CAT.6A STP - MANUAL DE INSTRUCCIONES

Publicado en 27-06-2024 por barpaadminuser



Instructions Manual

Field Term Plug • The Lyra

RJ45 Cat.6A STP - Toolless

- 1 Cut the cable and pull the rip cord and strip the jacket approximately 40 mm. Cut the excess shielding of the cable and the conductors. Fold the drain wire back along the cable jacket.



- 2 Apply the copper tape around the cable, position the drain wire on top of the tape, and complete the process by applying a second layer of copper tape over the drain wire, leaving the drain wire positioned between two layers of tape. This ensures improved electrical contact between the drain wire and the metallic part of the connector, which will be in direct contact with the copper tape.

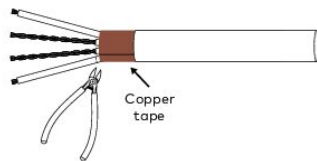

- 3 Position the aligner as illustrated in the figure. Pass the conductors through the aligner and insert each twisted pair into the corresponding slots according to the wiring instruction table and trim the conductors flush.

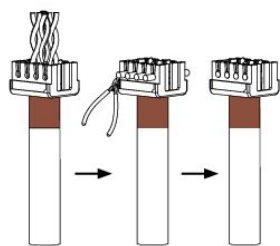

For correct termination, the conductor tip should protrude by a maximum of 0,1 mm.

- 4 Press the aligner onto the plug in the correct orientation. Ensure that the conductors are fully seated below the contact teeth inside the plug slots.

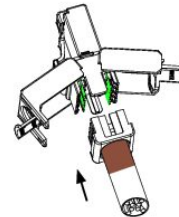

- 5 Close the outer cap by pressing down evenly on both sides until you hear a snap-in ("click") sound.

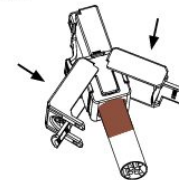

- 6 Make sure the copper tape is in contact with the shielded housing. Tighten and secure the assembly using the cable tie in the packaging.

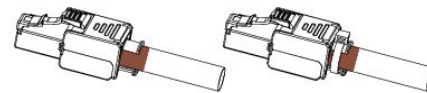

Done! Good Job!

	TIA/EIA T568A	TIA/EIA T568B
Jack Pin Designations	1 White/Green	White/Orange
	2 Green	Orange
	3 White/Orange	White/Green
	6 Orange	Green
	4 Blue	Blue
	5 White/Blue	White/Blue
	7 White/Brown	White/Brown
	8 Brown	Brown

